

MICROFILMED

S 85-29 E → 105'

5' UTILITY EASEMENT

FILED
GREENVILLE CO., S.C.
SEP 20 4 08 PM '85
DONNIE S. TANKERSLEY
R.M.C.

N 4-31 E → 200'

DRAINAGE EASEMENT

→ S 4-31 W 200'



← 135' TO REDCHERRY LANE

POWER SERVICES

10

58.3'

CONC. DRIVE

57'

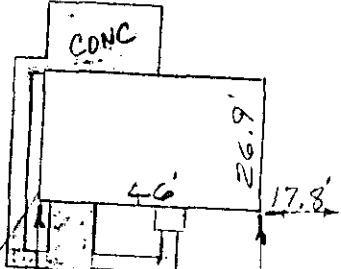

45' B.L.

→ N 85-29 W 105'

SEP 20 1985

FORESTDALE DRIVE

11Y-42

PROPERTY OF
SANDY A. CAMPBELL
REGINA L. CAMPBELL
GREENVILLE CO., S. C.
SEPT 19, 1985 SCALE 1"=40'

9923

This is to certify that on September 19, 1985, I surveyed the property shown on this plat known as Lot No. 19 and part of 20 as recorded on a plat of Forestdale Heights in the P.M. Office for Greenville County in Plat Book KK at Page 199, and that the the property lines, walls and buildings are as shown hereon, and that the building located on said lot does not project nor encroach on adjacent streets or property, and that no adjacent walls or buildings project nor encroach on said lot, and that no utility lines cross this lot except as may be shown hereon or for service thereto.

NOTE: This structure is not located within a flood hazard area.

Surveyed by: Richard D. Wooten, Jr.
Greenville, South Carolina

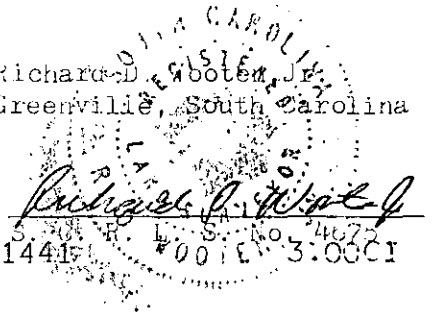

RECORDABLE PLAT

1441 SEP 20 1985 3:00CI